

" TECHNICAL DETAILS "

- Build in : 2015
- LOA : 12,35 m
- Beam : 3,96 m
- Draft : 2,05 m
- Engine : Volvo 55 HP
- F.Water Capacity : 360 L
- Diesel Capacity : 210 L
- Cabins : 3
- Berths : 6

" ALL INCLUDED "

- ★ AIRPORT TRANSFER
(Once Dalaman-Göcek-Dalaman)
- ★ TRANSITLOG
- ★ ENDCLEANING
- ★ BEDLINEN
- ★ TOWELS
- ★ OUTBOARD & DINGHY
- ★ MOBILE PHONE

Characteristics :

Furling Mainsail	43,0 m ²	Bow thruster	✓	Teak deck	---
Furling Genoa	39,0 m ²	Spinnaker with extra Payment..!	---	2 x Steeringwheel	✓
Sprayhood	✓	Spi-Boom	---	WC - Shower	2 + 2
				Cockpit laudspeakers	✓

Extra Characteristics : Big swimming platform

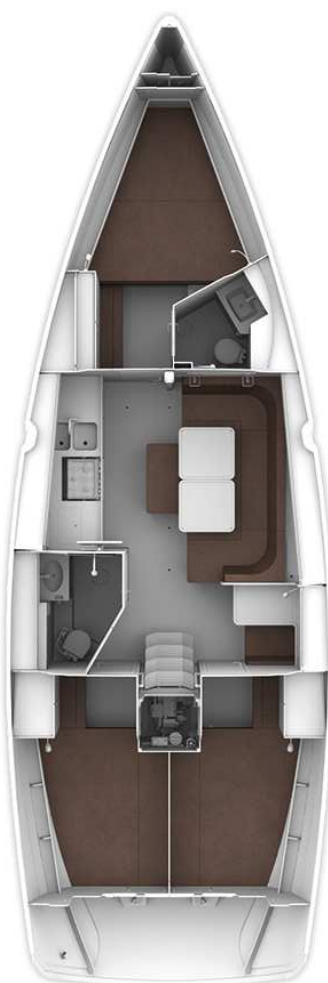

NAVIGATION & ELECTR. :

- ✓ GPS with Chartplotter
- ✓ Nav.Charts
- ✓ Nav. aids
- ✓ Nautical pilot books
- ✓ Compass
- ✓ Hand compass
- ✓ VHF
- ✓ Log instruments
- ✓ Anemometer
- ✓ Windex
- ✓ Automatic pilot
- ✓ Binocular
- ✓ Clock & Barometer
- ✓ Flag set
- ✓ Radio CD-Player with AUX+USB

ENGINE:

- ✓ Consumpt.-appr.3 l/h
- ✓ Diesel jerrycan 20 lt.full
- ✓ Funnel
- ✓ Spare V-Belt
- ✓ Spare impeller
- ✓ Spare engine oil
- ✓ Motor battery

ELECTRIC:

- ✓ Main circuit breaker
- ✓ Service batteries x5
- ✓ Inverter 12 V-220V
- ✓ 220 V Breaker / Fuses
- ✓ Battery charger 220 V
- ✓ Shore power cable
- ✓ Spare fuses
- ✓ Sockets 12 / 220 V
- ✓ Elctr. Repair set

MOORING:

- ✓ Windlass
- ✓ Anchor with 80 m inox chain
- ✓ Spare anchor
- ✓ 4 mooring lines 2x15 mt. & 2x30 mt.
- ✓ Shore line 1x40 mt.
- ✓ 6 Fenders
- ✓ 1 Baloon fender
- ✓ Gangway

SAFETY EQP. :

- ✓ Liferaft
- ✓ Danbuoy
- ✓ Life-Jackets
- ✓ Life-belts
- ✓ Manual bilge pump
- ✓ Elctr.bilge pump
- ✓ Distress signals
- ✓ Torch + batteries
- ✓ Foghorn
- ✓ Radar reflector
- ✓ Anchor ball
- ✓ Wire cutter
- ✓ First aid kit
- ✓ Fire extinguisher
- ✓ Fire blanket
- ✓ Tool box
- ✓ Emergency tiller
- ✓ Lifebuoy light
- ✓ Bosun chair
- ✓ Dinghy repair kit
- ✓ Sail repair kit

COMFORT:

- ✓ Bimini-Top
- ✓ Sun awning
- ✓ Cockpit-Cushions
- ✓ Safety net (upon request)
- ✓ Life jackets (kids)
- ✓ 3xWinch handels
- ✓ Cockpit table
- ✓ Cockpit light
- ✓ Oars & pump for dinghy
- ✓ Waterhose with adaptor
- ✓ Water can
- ✓ Benzinne jerry can -5 lt.
- ✓ Teak cockpit
- ✓ Swimming ladder
- ✓ Cockpit shower
- ✓ Boat-hook
- ✓ Bucket, Brush,Bailer
- ✓ Mask & Snorkel (1 set)
- ✓ 2 x Gas bottles
- ✓ Hotwater boiler
- ✓ F. water pres. pump
- ✓ 2 x Waste-water tank
- ✓ Gas cooker + Oven
- ✓ Fridge 12 V
- ✓ Sink
- ✓ Galley equipment
- ✓ Coffee filter
- ✓ Sponge,tea-towels
- ✓ Dish washing liquid
- ✓ Pegs
- ✓ Blankets, Pillows
- ✓ Welcome packet
- ✓ Etc.etc.

BASE : German, english languages, 24 hrs available & technical support, SMS-Info, SMS-Weather broadcast, Provision orders (upon request), reception, restaurant, bar, shower & WC..

GÖCEK : Clinic - Ambulance, banks, markets, shops, fresh market, laundry, car park, petrol station, rent a car, restaurants, bars and pubs...